

SPECIFICATION



(for illustration purposes only)

STAINLESS STEEL MESH INSTALLATION INFILL CONCRETE INSTALLATION

102E

Knock-out Block Post-Pour With Doorway Stepdown

Typical to Queensland and Northern Territory.



Global-Mark.com.au®
Manufactured under a
Management System certified as
complying with ISO 9001:2008.



CODEMARK™
GM-09-CM30012

Termimesh System Barrier parged to slab (not touching cyclone rods).

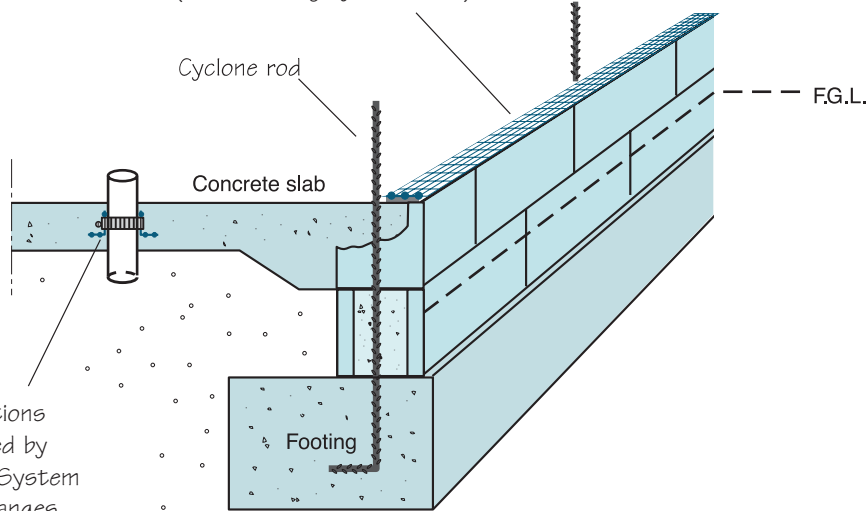

VIEW OF TYPICAL SLAB INSTALLATION

Termimesh System Barrier parged in stepdown so sill tiles can be angled for rainwater runoff.

Termimesh System Barrier parged to slab.

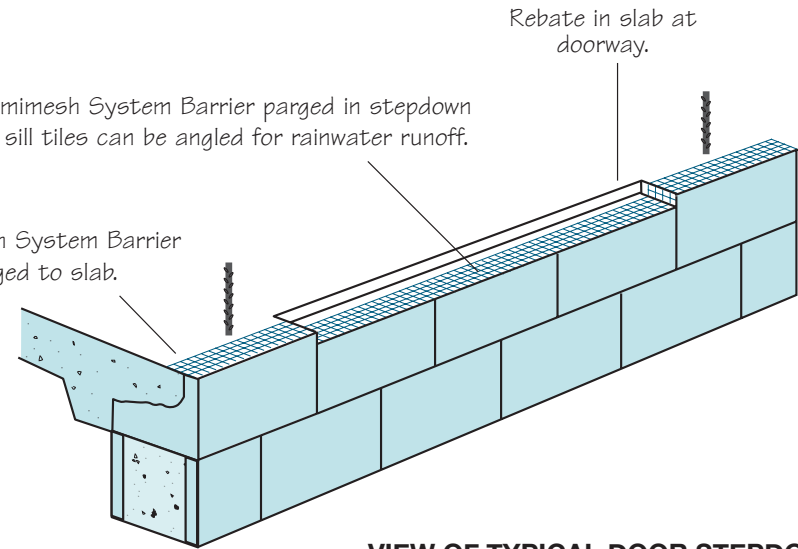

VIEW OF TYPICAL DOOR STEPDOWN

The rebate is generally formed by the concretor setting a strip of timber (approx. 10mm thick and 100mm wide) into the concrete for the full width of the doorway. The knock-out blocks are then cut to rebate level.

COPYRIGHT ©

TMA Corporation Pty Ltd
48 Century Road
MALAGA Western Australia 6090
ABN 90 009 452 475

Date: Dec 2004	Drawn: WB	Scale: NTS
Updated: Dec 2011		

The Termimesh System
For further information or additional specifications,
contact 1800 632 111 or www.termimesh.com

SPECN102E(SD)
QLB(iii)a.eps
QLB(iv).eps

Code
Spec
1.7