

SPECIFICATION

(for illustration purposes only)

STAINLESS STEEL MESH INSTALLATION RENDERED WALLS



Global-Mark.com.au®
Manufactured under a
Management System certified as
complying with ISO 9001:2008.

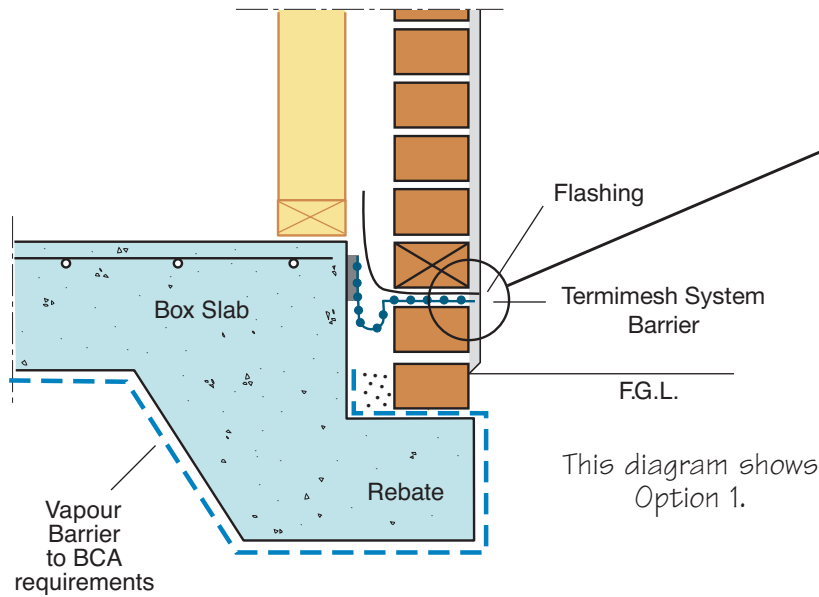

This diagram shows
Option 1.

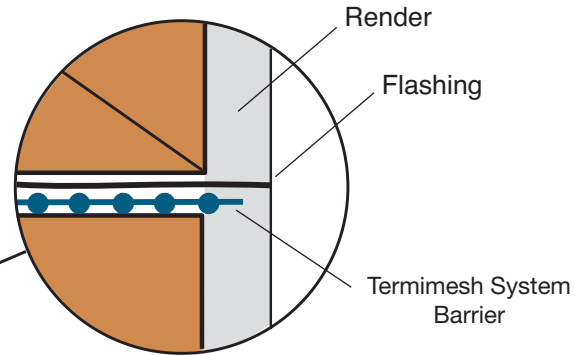

Option 1

Where the flashing is taken to the outer face of the render, the Termimesh System Barrier is installed under the flashing.

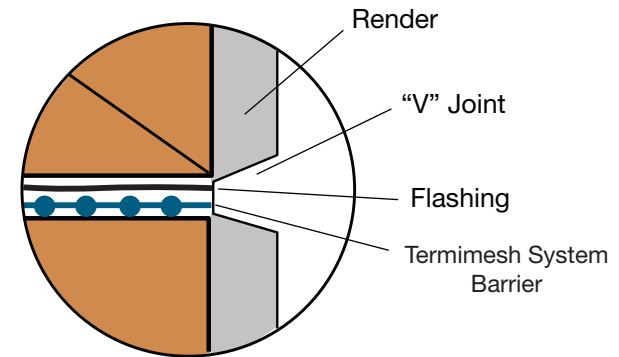

Option 2

COPYRIGHT ©

| | | |
|----------------------|--------------|---------------|
| Date: Dec 2004 | Drawn: WB | Scale: NTS |
| Updated: Dec 2011 | | |

The Termimesh System
For further information or additional specifications,
contact 1800 632 111 or www.termimesh.com

SPECNRender(i)
Diag102CRender(i).eps
Diag102CRender(i)b.eps

Code
Spec
8.1

TMA Corporation Pty Ltd
48 Century Road
MALAGA Western Australia 6090
ABN 90 009 452 475